

A1 FLOOR PLAN

700 SQUARE FEET

1 BEDROOM/1 BATH

3RD THROUGH 15TH FLOORS
PENTHOUSE 16TH AND 17TH FLOORS

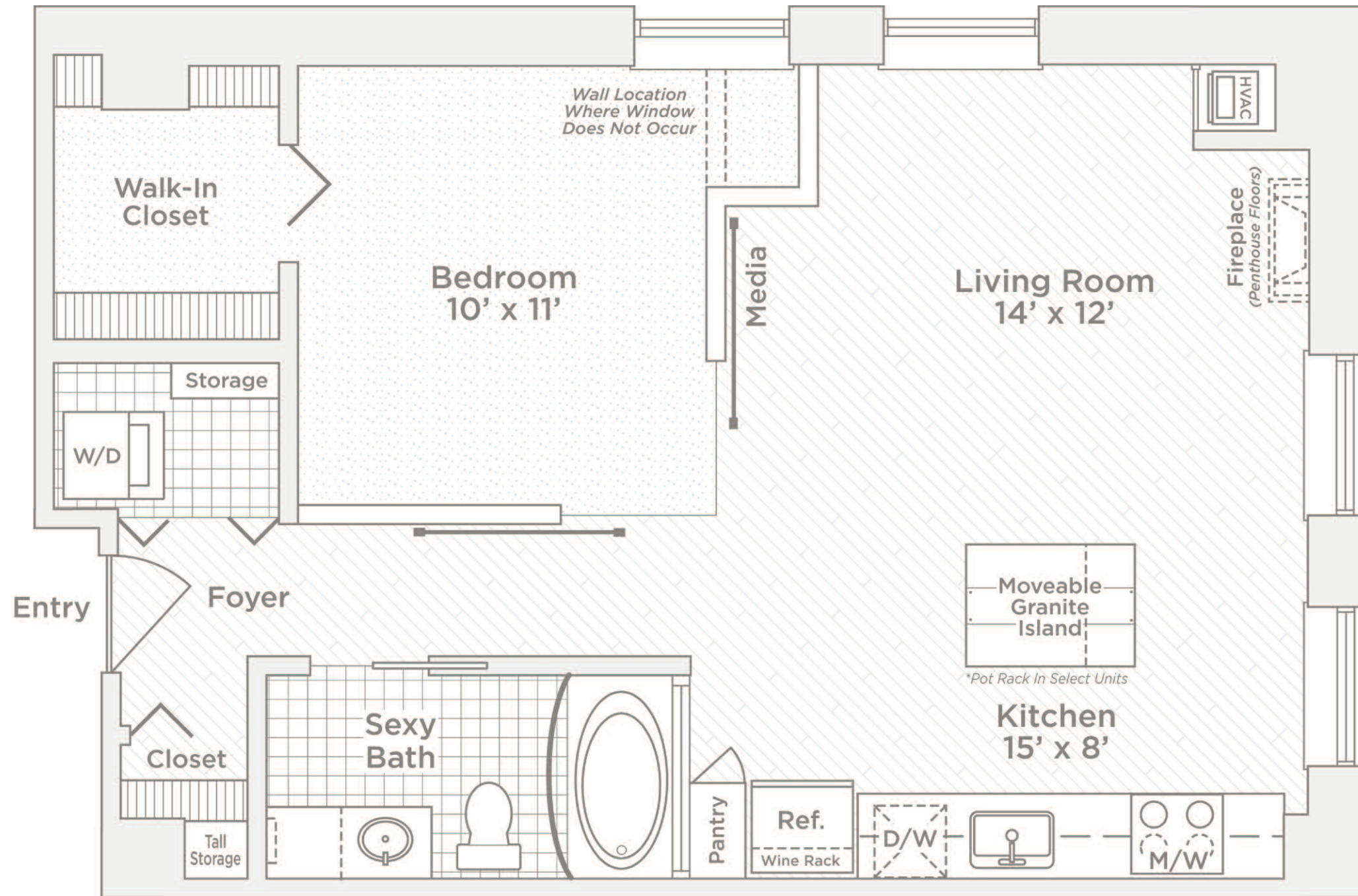

Unique one bedroom floor plan includes the following world-class features and premium amenities:

Two contemporary and unique finishing options available

Shaker style cherry cabinets with brushed nickel hardware, stainless steel Whirlpool® appliances, above-range microwave, porcelain tile backsplash, glass accent doors, built-in wine rack and pantry (*Penthouse Floors*)

Contemporary, white full-face kitchen cabinetry with brushed nickel hardware, white Whirlpool® appliances, above-range microwave, stainless steel backsplash, glass accent doors, built-in wine rack, pantry and pot rack

Granite countertops and moveable kitchen islands with built-in storage

Sexy bathroom with 36-inch soaking tub, graphic tile surrounds, porcelain tile floors, adjustable-height rain shower head, curved shower rod, cultured marble vanity, vessel sink, deep drawer storage, towel shelf, custom framed mirror and medicine cabinet (*Penthouse Floors*)

Sexy bathroom with 36-inch soaking tub, subway tile surround, black and white hexagon tile floors, adjustable-height rain shower head, curved shower rod, cultured marble vanity, deep drawer storage, towel shelf, custom framed mirror and medicine cabinet

Fireplace with cable TV outlet (*Penthouse Floors*)

Track lighting in kitchen and bath

Translucent sliding glass bedroom barn doors

Full-sized GE® stacked washer and dryer

Wood floors throughout living space

Berber carpet in bedroom

In-unit apartment storage and separate media nook

Large custom closets with single and double-hung shelving, wall-mounted shoe rack and linen closets

Soaring 10-foot ceilings

Oversized windows with window treatments

Heating and cooling with a 24/7/365 programmable thermostat

Sound controlled and energy efficient environment

Engineered and built to achieve the NAHB Green Building Standard

Space-saving pocket, bi-fold and barn doors

Natural light window in bathroom

V.A.L.U. Added Luxury Upgrades available

Artist's rendition. Floorplans and finishes vary by apartment. All dimensions approximate.

5/13



SOO LINE BUILDING
 CITY APARTMENTS

Your Name.....
 Your Apartment.....
 Your Address.....
 Date

101 South 5th Street | Minneapolis, MN 55402
 P: 612.808.6820 | F: 612.808.6821
soolinebldgcityapts.com

VILLAGEGREEN
 Lifestyle for Rent
EXPLORE VILLAGEGREEN.COM